



THE YALE BRAND

Yale is trusted by millions of people every day to keep what's important to them safe. Our innovations have protected their homes, families and belongings for over 180 years. We have expanded from being a leader in mechanical lock engineering to innovating connected smart locks and homes. Because we always make every effort to push the boundaries in a changing world. We were there for your grandparents (and probably theirs) and we'll be there for your children. Today, and every day to come.

Yale DWS
School Street, Willenhall,
West Midlands WV13 3PW, UK
T: 01902 366800 F: 01902 369041
www.yaledws.co.uk

April 2025 © ASSA ABLOY

Due to a continuous programme of development the company reserves the right to make alterations without notice. (Products which are not a stocked item will be subject to a longer lead time which needs to be agreed with your Yale representative).

Part of ASSA ABLOY



The VEKA OMNIA
compatible range
from Yale

The perfect match
for PAS 24:2022 compliance.



OMNIA
by imagine a VEKA plc brand

The VEKA OMNIA compatible range

Security meets innovation

Yale is leading the way in security innovation to provide a complete, fully PAS24:2022-compliant hardware package for OMNIA, the pioneering double flush, double rebated window and door profile from VEKA. Designed for seamless compatibility, superior security, and effortless adoption, our solution helps fabricators enhance their offering with confidence.

Every component in our hardware package has undergone rigorous testing to meet PAS24:2022 standards, delivering exceptional protection for both fabricators and end-users. The package includes:

- Lockmaster 21 Multipoint Door Lock
- Platinum 3-Star Cylinder
- Shootbolt & Encloser Window Locks
- Friction Stay Hinges
- Ancillary Security Devices

For enhanced security, we have incorporated Mila’s ProSecure Security Hinge—part of the ASSA ABLOY Group—creating a fully optimised and cohesive security solution.

Fabricators can leverage existing test evidence, eliminating additional testing costs and accelerating the transition to Yale hardware. Our cost-effective solution ensures a faster route to PAS24 compliance without compromising on security or performance.

Choose Yale’s industry-leading hardware package for VEKA OMNIA—where security, efficiency, and innovation come together.



Contents

Lockmaster 21 (172) Door Lock	Page 4
Lockmaster 21 (172) One Piece Keep	Page 5
French Doors - Passive Door Lock	Page 6
Yale Platinum 3 Star Cylinders	Page 7
Mila Prosecure Security HD Flush Door Hinge	Page 8
Yale Encloser Lock	Page 9
Yale Flush Sash Window Shootbolt 'Croppable'	Page 10
Yale Flush French Window Shootbolt 'Croppable'	Page 11
Yale Friction Hinges	Page 12
Window Security	Page 13
Defender Friction Hinges	Page 14

Lockmaster 21 (172) Door Lock

- Lockmaster’s signature hook and pin unit has been carefully positioned within 100mm of the pre-compression rollers
- Strengthened centre case with reverser offering enhanced security for added peace of mind
- Sprung and Unsprung centres with anti-separation hook as standard
- Pre-compression rollers
- Easy reversible latch bolt
- Tested as part of a PAS 24:2022 doorset



Lockmaster 21 (172) One Piece Keep

- 13mm axis handed one piece keep for durability and corrosion resistance, with a bespoke packer to secure to OMNIA Profile
- +/- 2mm compression adjustment
- Screw-in strengthened plastic tidy-boxes offering improved longevity and a more aesthetically pleasing look

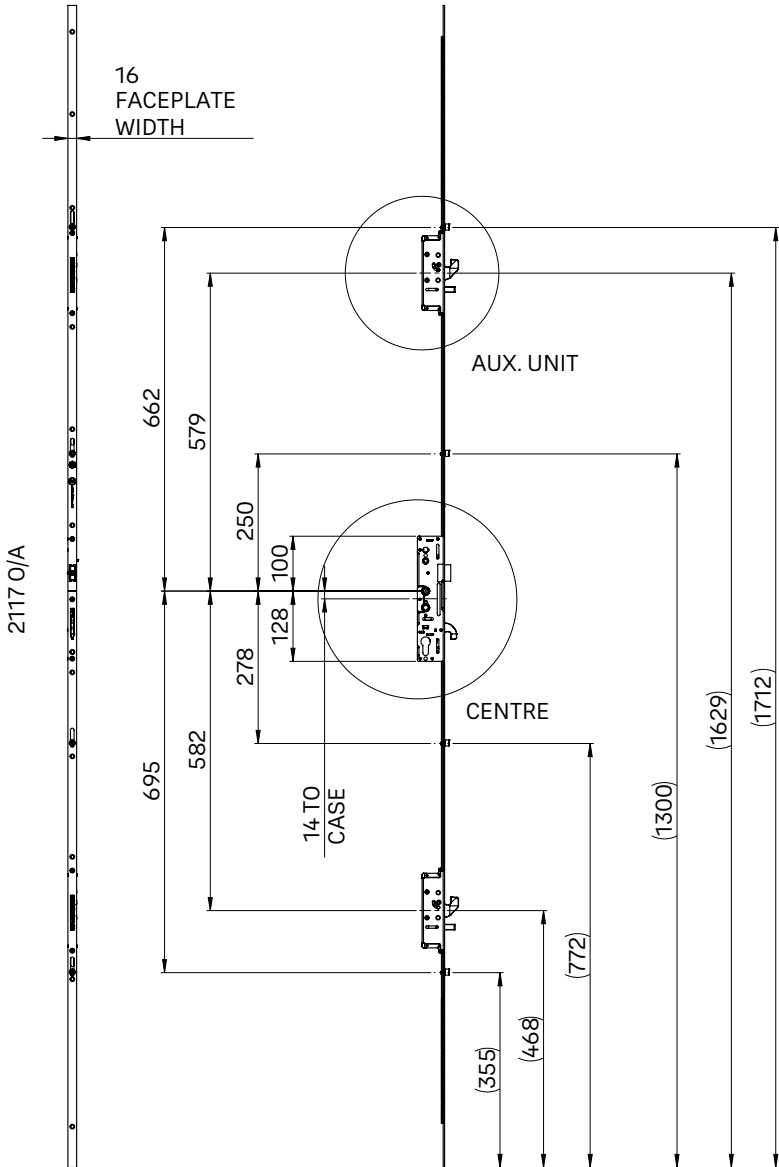

Part numbers - Locks and One Piece Keeps

YL21S-35H-172-27	Lockmaster 21: 3 Hook with 2 Anti Lift, 4 Roller, Sprung, Extendable, 35mm Back Set
YL21-35H-172-27	Lockmaster 21: 3 Hook with 2 Anti Lift, 4 Roller, Unsprung, Extendable, 35mm Back Set
YLK13-001L-172	One Piece Keep, Lockmaster 21 Left Hand, to suit lock 172
YLK13-002R-172	One Piece Keep, Lockmaster 21 Right Hand, To suit lock 172
YKP242	VEKA OMNIA Push in Packer

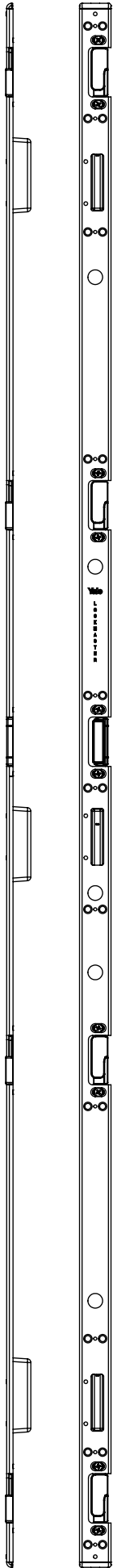

French Doors Passive Door Lock

- Extendable French Door Lock
- 35mm / PZ92mm centre case Sprung centre cases
- Lever operated
- Euro cylinder profile
- Non-handed mechanism
- 16mm faceplate

Yale Platinum 3 Star Cylinders

- TS007-1:2014+A2:2018
3 Star accredited
- Sacrificial external side to defend against snap attacks
- Available in brass and Nickel finishes

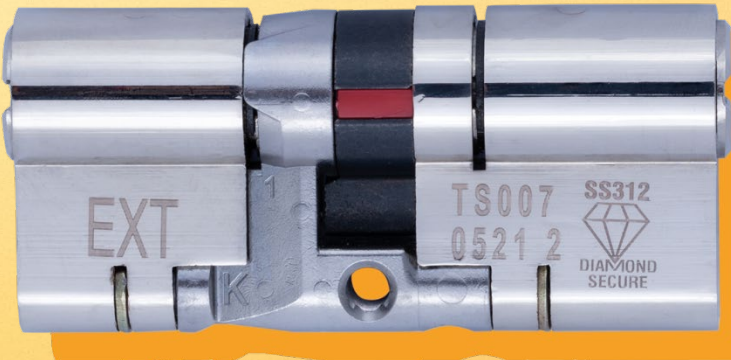

10
YEAR
MECHANICAL
GUARANTEE

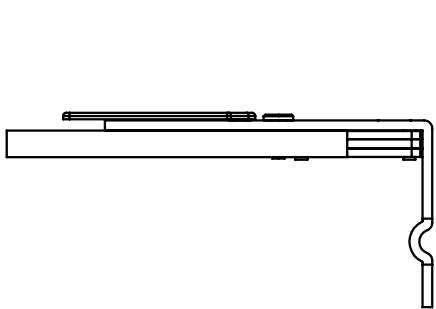

Part numbers - Locks, Shoot Bolt and Keeps

YLS312-35S-27	Lockmaster Passive, Sprung, Extendable, 35mm Back Set
PLSB88-19	Top & Bottom Shootbolt Set - 150mm / 100mm High Security
PLK963-19	Single Adjustable Shootbolt Keep
PLK941-19	Double Adjustable Shootbolt Keep
PLK941-C03	Shoot Keep Box Tidy (2 x req)

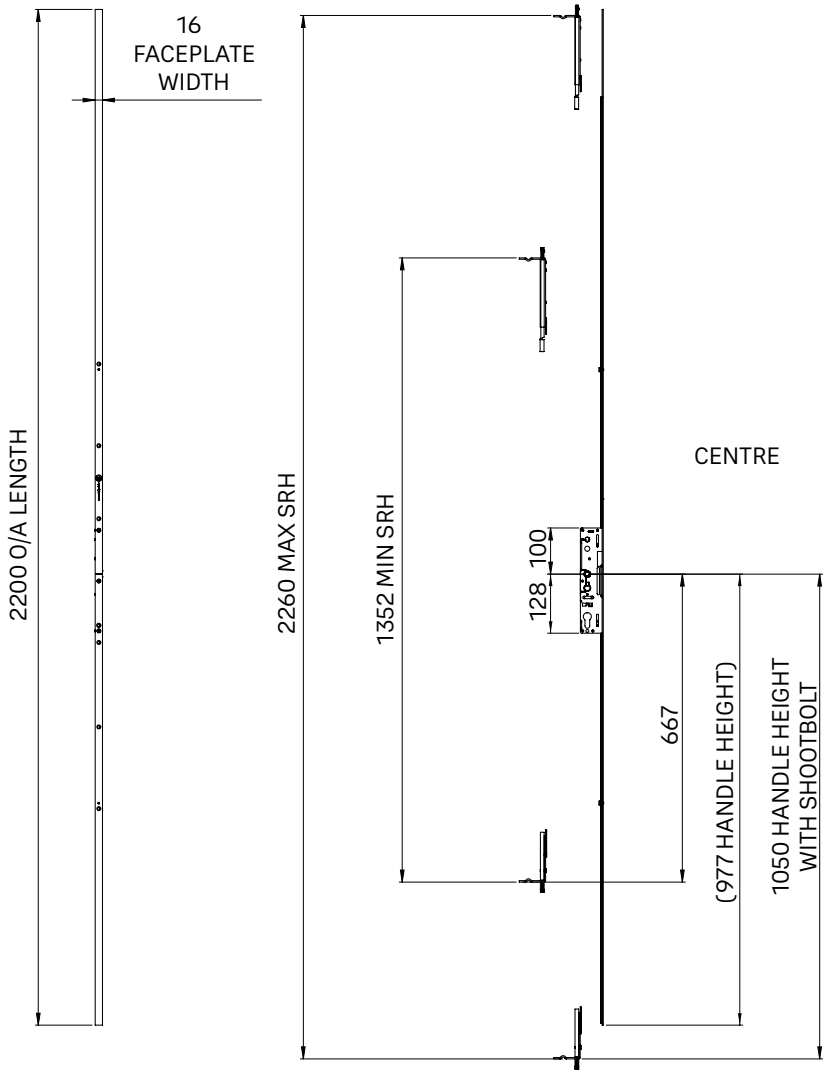

Part numbers - Double - Key Differ

YS3-4550B	45/50 (95mm) Platinum 3 Star, Double Key Differ Cylinder, Brass
YS3-4550N	45/50 (95mm) Platinum 3 Star, Double Key Differ Cylinder, Nickel
YS3-5045B	50/45 (95mm) Platinum 3 Star, Double Key Differ Cylinder, Brass
YS3-5045N	50/45 (95mm) Platinum 3 Star, Double Key Differ Cylinder, Nickel

Part numbers - Double - Paired Alike

YS3-4550BPA	45/50 (95mm) Platinum 3 Star, Double Paired Alike Cylinder, Brass
YS3-4550NPA	45/50 (95mm) Platinum 3 Star, Double Paired Alike Cylinder, Nickel
YS3-5045BPA	50/45 (95mm) Platinum 3 Star, Double Paired Alike Cylinder, Brass
YS3-5045NPA	50/45 (95mm) Platinum 3 Star, Double Paired Alike Cylinder, Nickel

Part numbers - Thumbturn - Key Differ

YS3-4550BTT	45/50 (95mm) Platinum 3 Star, Thumbturn Key Differ Cylinder, Brass
YS3-4550NTT	45/50 (95mm) Platinum 3 Star, Thumbturn Key Differ Cylinder, Nickel
YS3-5045BTT	50/45 (95mm) Platinum 3 Star, Thumbturn Key Differ Cylinder, Brass
YS3-5045NTT	50/45 (95mm) Platinum 3 Star, Thumbturn Key Differ Cylinder, Nickel

Mila Prosecure Security HD Flush Door Hinge

- Security tested to PAS 24: 2022
- Highly corrosion resistant to BS EN 1670:2007 Grade 5
- Ultra-long life assured – tested to BS EN 1670:2007 achieving 200,00 cycles under 100kg load
- With sub-40 second fitting times achieved under test conditions, the ProSecure Pace Security hinge has been designed to speed up door fabrication without compromising on quality and aesthetics
- Quick and fuss-free 3D adjustment (+/- 5mm lateral, + 5mm vertical and +/- 1mm compression adjustment)
- Captive hinge lid means fixing screws are easy to access for a faster, straight-forward fit
- Rubber tongue keeps hinge lid open until installation is finished
- Static-cling TechTape provides scratch-protection during transit, fitting and installation
- 13 different finishes available

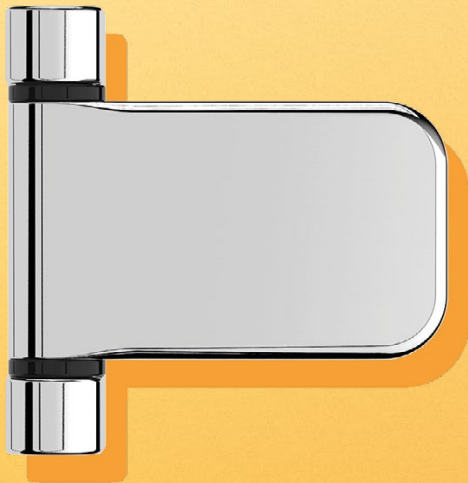

Yale Encloser Lock

- Bi-directional locking cams
- 7.7mm, 9mm and 10.5mm mushroom cam heights 20mm and 22mm backset variants
- Simple compression adjustment
- Suitable for sash sizes 270mm to 1400mm
- 7 models covering 2, 4 and 6 mushrooms
- Suitable for use on PVC, Aluminium and Timber



Part numbers - Door Hinge

027340	ProSecure Flush Door Hinge (HD), White, Bulk Packed, R/H
027341	ProSecure Flush Door Hinge (HD), Brown, Bulk Packed, R/H
027342	ProSecure Flush Door Hinge (HD), Gold (PVD), Bulk Packed, R/H
027343	ProSecure Flush Door Hinge (HD), Light Oak, Bulk Packed, R/H
027344	ProSecure Flush Door Hinge (HD), Polished Chrome, Bulk Packed, R/H
027345	ProSecure Flush Door Hinge (HD), Black, Bulk Packed, R/H
027346	ProSecure Flush Door Hinge (HD), Satin Silver, Bulk Packed, R/H
027359	ProSecure Flush Door Hinge (HD), Anthracite Grey, Bulk Packed, R/H

027360	ProSecure Flush Door Hinge (HD), White, Bulk Packed, L/H
027361	ProSecure Flush Door Hinge (HD), Brown, Bulk Packed, L/H
027362	ProSecure Flush Door Hinge (HD), Gold (PVD), Bulk Packed, L/H
027363	ProSecure Flush Door Hinge (HD), Light Oak, Bulk Packed, L/H
027364	ProSecure Flush Door Hinge (HD), Polished Chrome, Bulk Packed, L/H
027365	ProSecure Flush Door Hinge (HD), Black, Bulk Packed, L/H
027366	ProSecure Flush Door Hinge (HD), Satin Silver, Bulk Packed, L/H
027379	ProSecure Flush Door Hinge (HD), Anthracite Grey, Bulk Packed, L/H



Part numbers - Window Locks

YWBL1-2209-19	Encloser Size 1, 270mm - 350mm 22mm B/S 9mm Cam (2 x Keeps) 250mm
YWBL2-2209-19	Encloser Size 2, 350mm - 600mm 22mm B/S 9mm Cam (2 x Keeps) 350mm
YWBL3-2209-19	Encloser Size 3, 550mm - 800mm 22mm B/S 9mm Cam (2 x Keeps) 550mm
YWBL4-2209R-19	Encloser Size 4, 750mm - 950mm 22mm B/S 9mm Cam (3 x Keeps) 750mm
YWBL5-2209R-19	Encloser Size 5, 900mm - 1100mm 22mm B/S 9mm Cam (3 x Keeps) 900mm
YWBL3-2209-19	Encloser Size 6 1050mm - 1250mm 22mm B/S 9mm Cam (3 x Keeps) 1050mm
YWBL7-2209R-19	Encloser Size 7, 1200mm - 1400mm 22mm B/S 9mm Cam (3 x Keeps) 1200mm
YWK257-19	Mushroom Keep - VEKA OMNIA

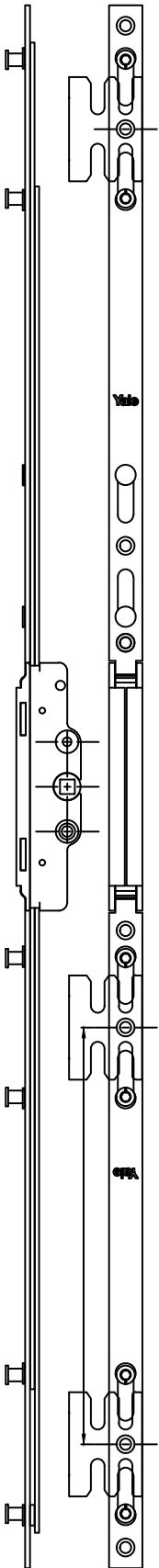

Yale Flush Sash Window Shootbolt 'Croppable'

- Secondary cam for night vent feature
- High security shootbolt system
- Adjustable 7.7mm and 9mm mushroom cams 20mm and 22mm backsets
- Profile related keeps
- 4 crop to fit shootbolt rod sizes to achieve sash sizes 326mm and 1420mm
- Also available in a non-crop variant with an extendable gearbox and 7 rod sizes covering sash sizes 522mm to 1510mm



Yale Flush French Window Shootbolt 'Croppable'

- Secondary cam for night vent feature
- High security shootbolt system
- Adjustable 7.7mm and 9mm mushroom cams 20mm and 22mm backsets
- Profile related keeps
- 4 crop to fit shootbolt rod sizes to achieve sash sizes 326mm and 1420mm
- Also available in a non-crop variant with an extendable gearbox and 7 rod sizes covering sash sizes 522mm to 1510mm



Part Numbers - Croppable Gearbox

YSGC922-19	Croppable Gearbox 22 B/S 9mm Cam
-------------------	----------------------------------

Part Numbers - Standard Extension Rods

YWR0-19	Rod '0' No Cam
YWRFF3L-09-19	Standard Flush Fit Shootbolt Assembly Size 3 LH 9mm Cam
YWRFF5L-09R-19	Standard Flush Fit Shootbolt Assy + Rivet Size 5 LH 9mm Cam
YWRFF7L-09R-19	Standard Flush Fit Shootbolt Assy + Rivet Size 7 LH 9mm Cam
YWR0-19	Rod '0' No Cam
YWRFF3R-09-19	Standard Flush Fit Shootbolt Assembly Size 3 RH 9mm Cam
YWRFF5R-09R-19	Standard Flush Fit Shootbolt Assy + Rivet Size 5 RH 9mm Cam
YWRFF7R-09R-19	Standard Flush Fit Shootbolt Assy + Rivet Size 7 RH 9mm Cam

Part Numbers - Keeps

YWK257-19	Mushroom Keep - VEKA OMNIA
YWK457-19	LH Corner Keep - VEKA OMNIA
YWK657-19	RH Corner Keep - VEKA OMNIA

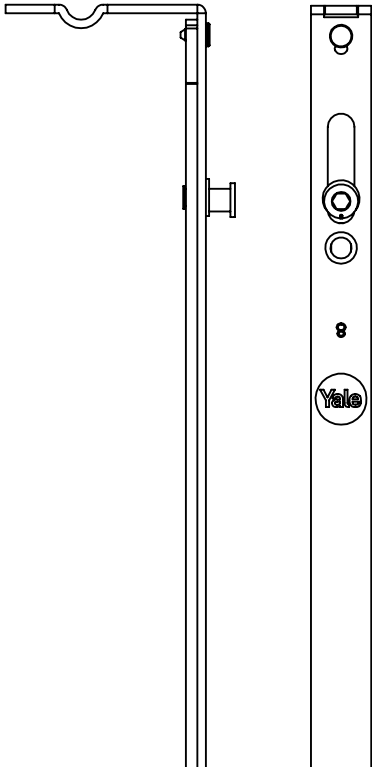

Part Numbers - Croppable Gearbox

YSGC922-19	Croppable Gearbox 22 B/S 9.0mm Cam
-------------------	------------------------------------

Part Numbers - Standard Extension Rods

YWR0-19	Rod '0' No Cam
YFWRFF3L-09-19	French Flush Fit Shootbolt Assembly Size 3 LH 9mm Cam
YFWRFF5L-09R-19	French Flush Fit Shootbolt Assembly with Rivet Size 5 LH 9mm Cam
YFWRFF7L-09R-19	French Flush Fit Shootbolt Assembly with Rivet Size 7 LH 9mm Cam
YWR0-19	Rod '0' No Cam
YFWRFF3R-09-19	French Flush Fit Shootbolt Assembly Size 3 RH 9mm Cam
YFWRFF5R-09R-19	French Flush Fit Shootbolt Assembly with Rivet Size 5 LH 9mm Cam
YFWRFF7R-09R-19	French Flush Fit Shootbolt Assembly with Rivet Size 7 LH 9mm Cam

Part Numbers - Extension Rods

YSGC022-19	Croppable Gearbox 22 B/S No Cam
YWR0-19	Rod '0' No Cam
YWR3-R-19	Rod '3' Rivet Assembly (French Windows)
YWR5-R-19	Rod '5' Rivet Assembly (French Windows)
YWR7-R-19	Rod '7' Rivet Assembly (French Windows)

Part Numbers - Keeps

YWK257-19	Mushroom Keep - VEKA OMNIA
YWK457-19	LH Corner Keep - VEKA OMNIA
YWK657-19	RH Corner Keep - VEKA OMNIA
YWSK800-19	French Shootbolt Keep

Yale Friction Hinges

- Excellent weather sealing and draught proofing performance from extended enclosed end cap and asymmetrical vent arm.
- Compatible with PVCu, timber and aluminium windows
- Standard and highline stack heights
- Slider with friction
- Made from ferritic stainless steel
- 10-Year Mechanical Guarantee
- Included in the Lifetime Guarantee (Terms and conditions apply)

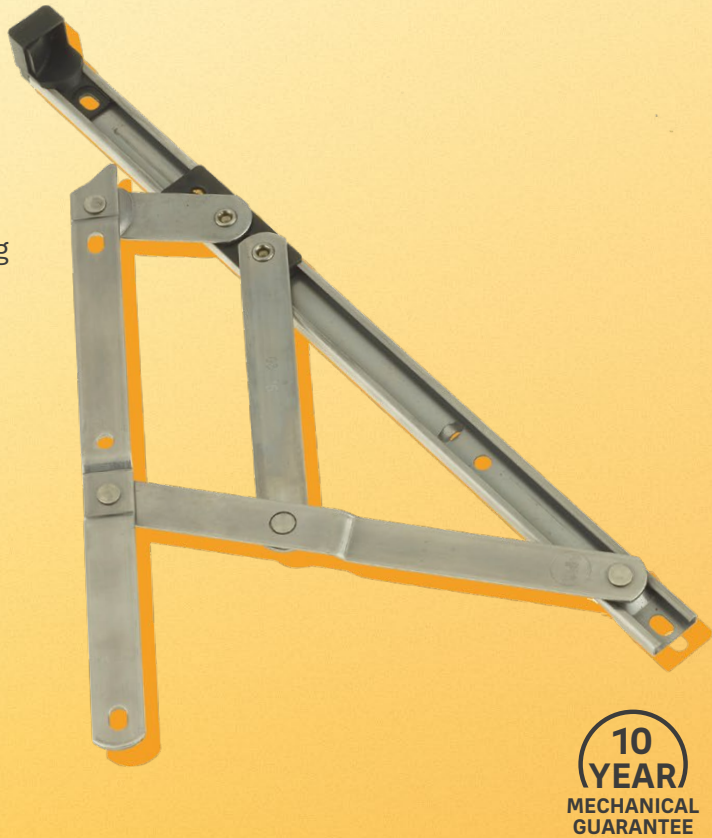

Window Security

A secure solution to windows offering easy egress without affecting the opening and closing performance of the hinge.

Features

- Visibly effective yet unobtrusive
- Suitable for cavity sizes from 13mm to 18mm
- Easy to fit - no routing required
- Pressed stainless
- Yale branded
- 1 set of 4 required per vent



Part Numbers - Top hung and side hung

YT10-H	10" Top Hung 16mm Stack Height
YT16-H	16" Top Hung 16mm Stack Height
YT20-H	20" Top Hung 16mm Stack Height
YT24-H	24" Top Hung 16mm Stack Height
YU8-H	8" Universal 16mm Stack Height
YU12-H	12" Universal 16mm Stack Height
YS16-H	16" Side Hung 16mm Stack Height
YE012-H7	12" Side Hung 16mm Stack Height "Egress Only"
YE016-H7	16" Side Hung 16mm Stack Height "Egress Only"
YEC12-H7	12" Side Hung 16mm Stack Height "Egress Easy Clean"
YEC16-H7	16" Side Hung 16mm Stack Height " Egress Easy Clean"

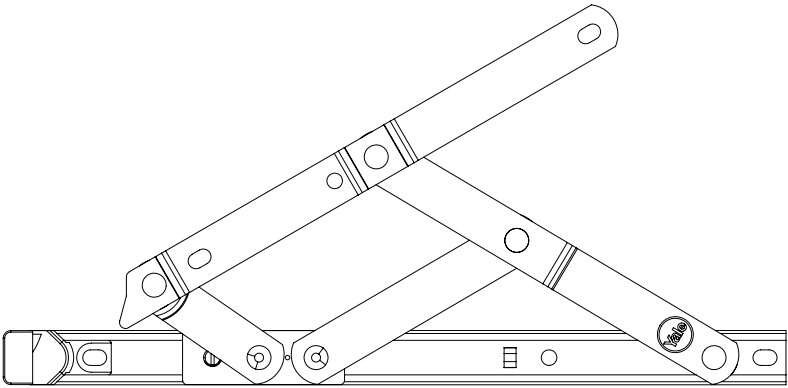

Part Numbers

ASD-ST2	Yale Excluder Ancillary Security Device
---------	---

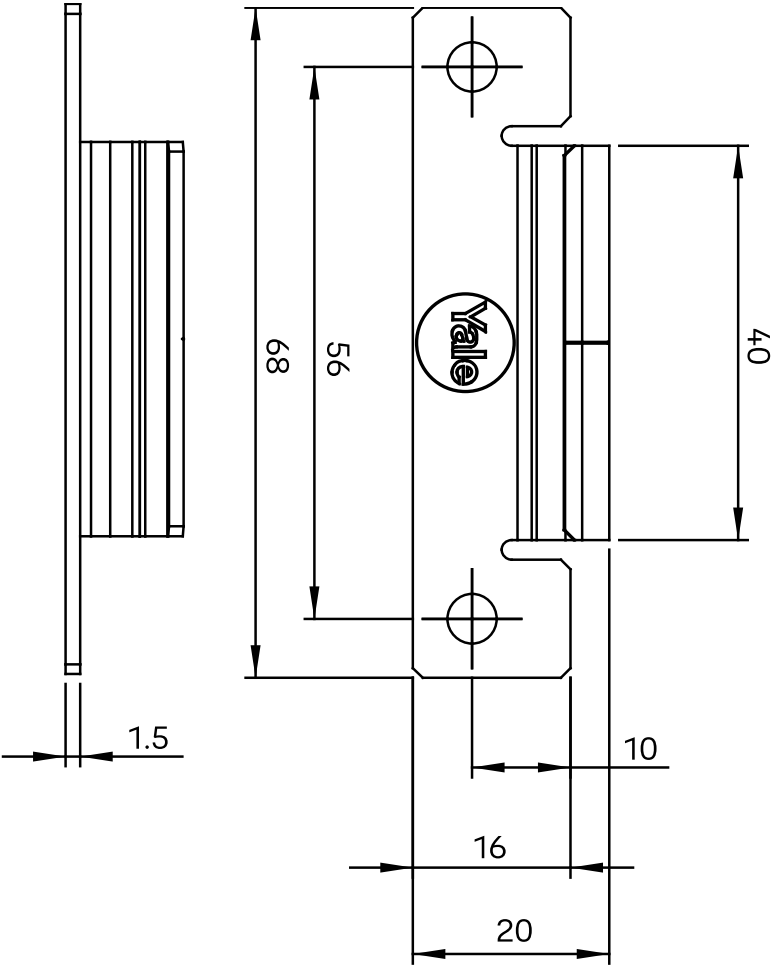

Defender Friction Hinges

- Improved weather sealing and draught proofing performance from extended enclosed end cap and asymmetrical vent arm form to BS 6375-1
- Lipped slider for enhanced smooth operation
- Easy friction adjustment without metal to metal contact
- Unique robust cam friction device eliminates the risk of screw misuse
- Ability to carry a load of up to 50kg top-hung and 40kg side-hung
- Asymmetric location system for reliable and accurate closure
- Enclosed end cap to prevent ingress of debris and provide increased cavity tolerance
- Slot-hole-slot format allowing for easier vent adjustment
- Highline variants available for deeper profiles with cavities between 16mm and 18mm
- Available in ferritic 430* as standard or austenitic 304* stainless steel for enhanced corrosion resistance
- Restricted variant available

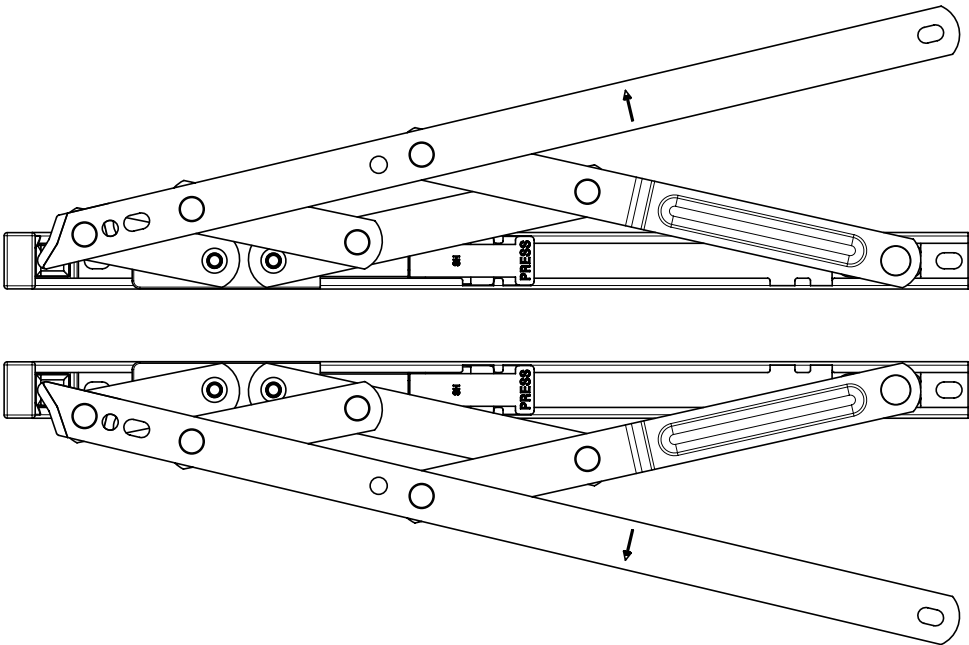
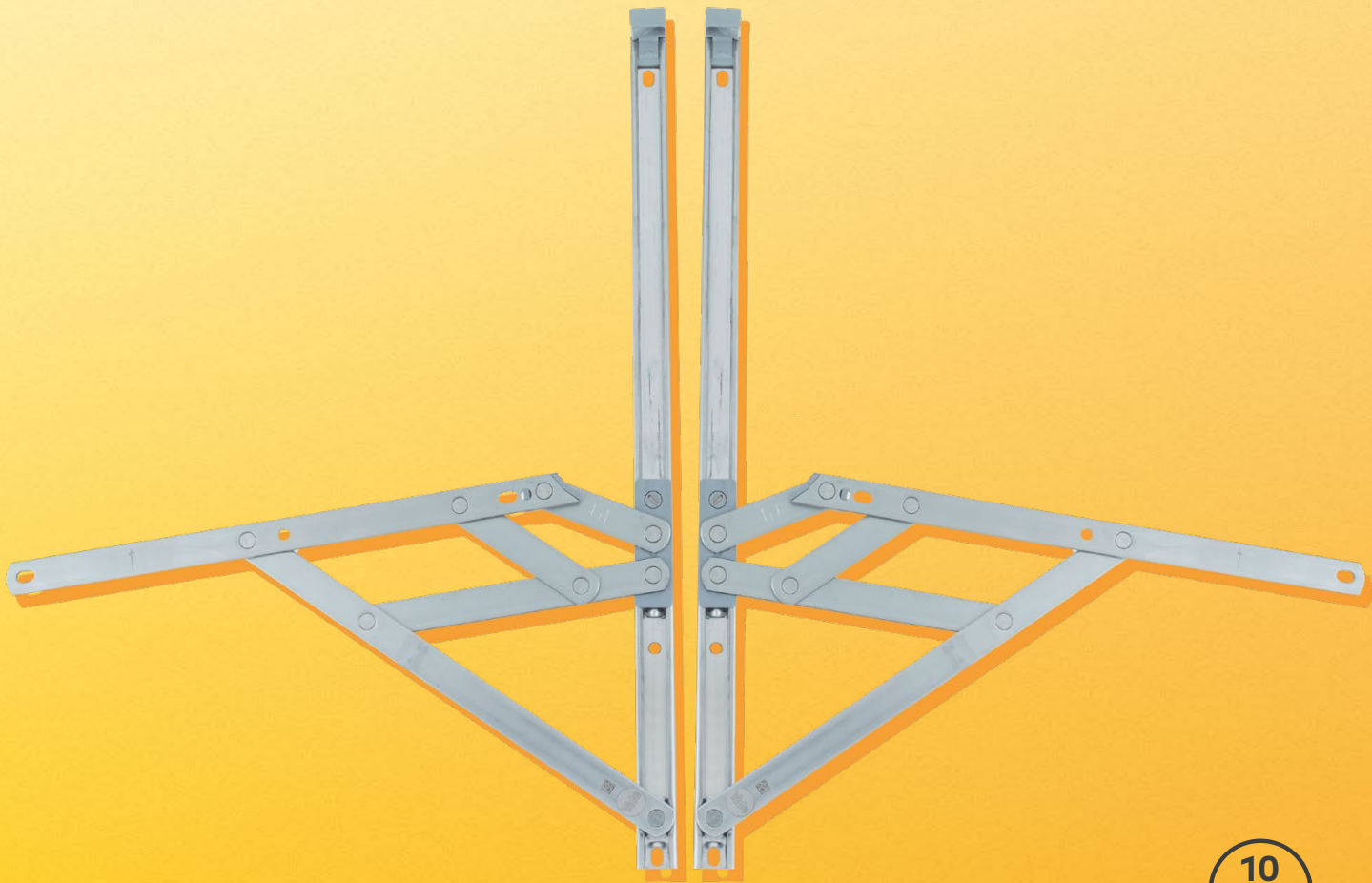

Part Numbers - Defender Friction Hinges (highline 17mm st/ht)

ED8H7	8" Top Hung 17mm Stack Height
EDT10H7	10" Top Hung 17mm Stack Height
EDT12H7	12" Top Hung 17mm Stack Height
EDT16H7	16" Top Hung 17mm Stack Height
EDT20H7	20" Top Hung 17mm Stack Height
EDT24H7	24" Top Hung 17mm Stack Height
EDS12H7	12" Side Hung 17mm Stack Height
EDS16H7	16" Side Hung 17mm Stack Height
EDSE12H7	12" Side Hung 17mm Stack Height "Egress"
EDSE16H7	16" Side Hung 17mm Stack Height "Egress Easy Clean"

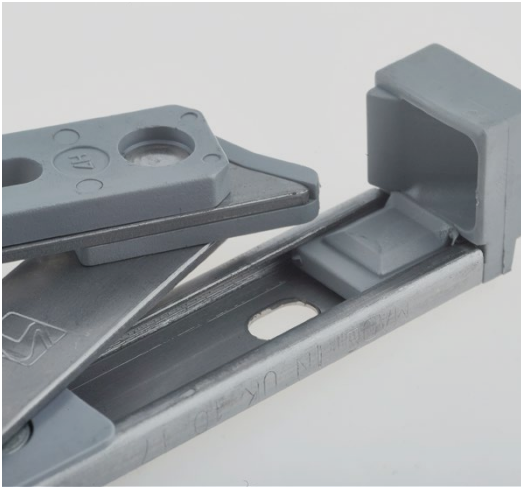

Part Numbers - Defender Friction Hinges "Restricted" (highline 17mm ST/HT)

EDTR12H7	12" Top Hung Restricted 17mm Stack Height
EDTR16H7	16" Top Hung Restricted 17mm Stack Height
EDTR16H7	20" Top Hung Restricted 17mm Stack Height
EDTR24H7	24" Top Hung Restricted 17mm Stack Height
EDSR12H7-PL	12" Side Hung Restricted 17mm Stack Height (LH Restricted, RH Standard)
EDSR12H7-PR	12" Side Hung Restricted 17mm Stack Height (RH Restricted, LH Standard)
EDSR16H7-PL	16" Side Hung Restricted 17mm Stack Height (LH Restricted, RH Standard)
EDSR16H7-PR	16" Side Hung Restricted 17mm Stack Height (RH Restricted, LH Standard)

